

## Plans Lodged for New Dwellings at Three Kings

*Fletcher Residential files two private plan change applications with Auckland Council*

### **Auckland – 19 September 2014**

Fletcher Residential has lodged two private plan change applications with Auckland Council for the redevelopment of Three Kings Quarry. These applications outline two ways to transform the area into a new urban precinct.

The quarry is located at the southern end of Mt Eden Road, eight kilometres from Auckland's central business district. New links will be created to connect the development's housing precincts with Three Kings town centre and the volcanic cone Te Tātua a Riukiuta Maunga (Big King).

The Three Kings development promotes housing diversity with a range of high quality dwellings including two-to-three storey terrace homes, three-to-four storey apartments and 10-storey cascading apartments set against the quarry slope.

Fletcher Residential's preferred plan change application involves exchanging land to better utilise surrounding Crown land. This will create significant recreational space with two sports fields, a Town Square connecting the precinct to the Three Kings town centre, a convention centre and the historic Three Kings Oval.

Steve Evans, Chief Operating Officer of Housing at Fletcher Building says two plan changes have been submitted to the Auckland Council to provide options of how best to develop the site holistically and in keeping with its surroundings.

"This is one of the last significant blocks of land close to the city and can deliver diverse housing solutions at scale that will help to alleviate Auckland's need for high quality housing. It's important that we provide an integrated residential, recreational and retail precinct for this community," says Evans.

In addition to the Town Square, the preferred proposal on the 21.6 hectare site also features open spaces including two sports fields, recreational parkland and a wetland terrace for residents and the surrounding community. The sports fields would complement the existing Three Kings Park and support cricket in the summer and soccer in the winter.

Fletcher Residential's preferred option is supported by a range of community groups. Steven Reid, General Manager at Three Kings United Football says Fletcher Residential's preferred proposal will deliver new amenities to the local community.

"The comprehensive plan for the development at Three Kings Reserve will bring much needed football pitches for all of our members and families at Three Kings United Football. It will allow a space that's currently underutilised, to be developed in a way that offers benefits to the wider community for recreation and year-round sports," says Reid.

Fletcher Residential's second private plan change option would see development only on the company owned 15.2 hectare Three Kings Quarry site. This option presents the same housing precincts however, it delivers less extensive community spaces and sports fields than the preferred proposal.

It is anticipated that the plan changes will be heard by Auckland Council in early 2015. Further information is available at [www.three-kings.co.nz](http://www.three-kings.co.nz).

ENDS

*Below is an artist's impression of the development. A high res file is available on request.*

For further information contact:

Philip King  
Group General Manager, Investor Relations & Capital Markets  
Fletcher Building Limited  
Phone: 09 525 9043  
Mobile: 027 444 0203  
Email: [Philip.King@fb.co.nz](mailto:Philip.King@fb.co.nz)

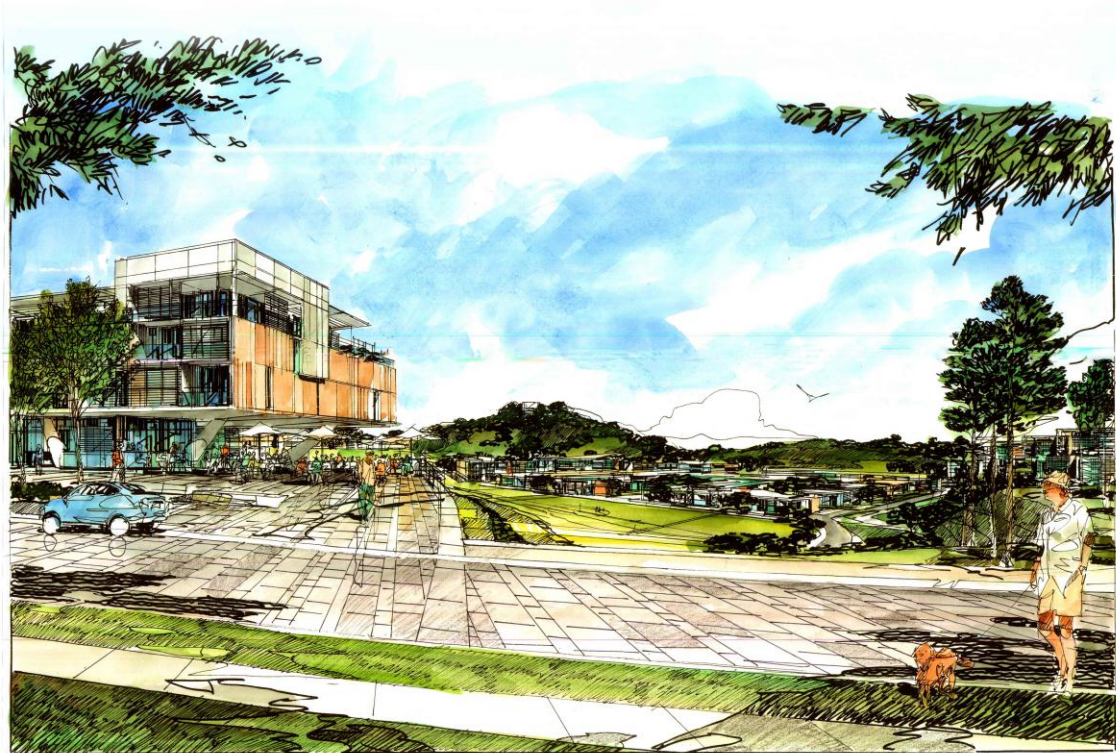

THREE KINGS RENEWAL - SEPTEMBER 2014  
These plans outline the vision of Fletcher Residential Ltd and are not endorsed by Auckland Council.

 SBB ARCHITECTS INC.  FLETCHER RESIDENTIAL